

# EDGE LINERS & GROMMETS



## EGL Series

Caplug No.	Dimensions								Packaging				Mini Pak Quantity	Caplug No.
	Metal Thickness		A		B		Minimum Bend Radius		Standard Carton		Length			
	in	mm	in	mm	in	mm	in	mm	Shipping Wt. (Approx.)	lbs		kgs		
EGL-11-2	.05-.081	1.27 - 2.03	.15	3.81	.17	4.32	.75	19.05	3	1.3	500	152	N/A	EGL-11-2
EGL-11-3	.07-.121	1.78 - 3.05	.16	4.06	.22	5.59	1.00	25.40	6	2.7	500	152	N/A	EGL-11-3
EGL-12-1/4	.13-.283	3.30 - 7.11	.27	6.86	.42	10.67	2.00	50.80	7	3.1	150	46	N/A	EGL-12-1/4
EGL-12-1/2	.25-.506	6.35-12.70	.40	10.16	.68	17.27	2.50	63.50	8	3.6	125	38	N/A	EGL-12-1/2
EGL-12-3/4	.38-.759	9.65-19.05	.46	11.68	.93	23.62	3.00	76.20	8	3.6	100	31	N/A	EGL-12-3/4
EGL-22-4	.01-.120	.25 - 3.05	.65	16.51	.26	6.60	-	-	15	6.8	500	152	N/A	EGL-22-4
EGL-22-6	.11-.182	2.79 - 4.57	1.00	25.40	.34	8.64	-	-	14	6.3	250	76	N/A	EGL-22-6

## CEG Series

Caplug No.	Dimensions						Packaging			Mini Pak Quantity	Caplug No.
	Metal Thickness		A		B		Standard Carton**		No. of Pieces		
	in	mm	in	mm	in	mm	Shipping Wt. (Approx.)	lbs			
CEG-23-1	0.03	0.76	0.48	12.19	0.17	4.32	14	6.3	100	20	CEG-23-1
CEG-23-2	0.06	1.52	0.48	12.19	0.20	5.08	14	6.3	100	20	CEG-23-2
CEG-23-2N	0.06	1.52	0.28	7.11	0.19	4.82	12	5.4	150	30	CEG-23-2N

\*\* All CEG Conductive Edge Liners are packaged in static dissipative poly bags.

Note: EGL and CEG Series also stocked in popular cut lengths, or we will custom-cut lengths for your particular requirements.



# EDGE LINERS & GROMMETS

## GRO Series Grommets for Holes in Sheet Metal



Mechanical protection for hoses, tubing, shafts, rods, and cables as they pass through holes in sheet metal is provided by Series GRO grommets. Easily snapped in place, they are held securely by a molded bead until deliberately removed. U.L. approved for applications up to 221°F (105°C).



**MATERIAL\*:** Flex Temp  
**COLOR\*:** Black

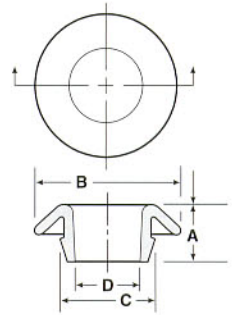

## TES Series Tamper-Evident Seal



Series TES Tamper-Evident Seals provide a positive, self-locking chain that breaks upon activating, thereby indicating that the seal, lock, or device has been disturbed.



**MATERIAL\*:** Polypropylene  
**COLOR\*:** Black, Blue, Brown, Green, Orange, Pink, Purple, Red, White, Yellow

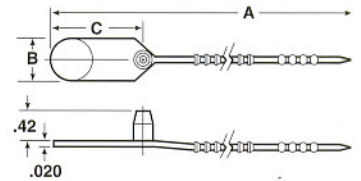

# EDGE LINERS & GROMMETS



## GRO Series

Caplug No.	Dimensions												Packaging				Caplug No.
	Hole Size		Metal Thickness		A		B		C		D		Standard Carton		Mini Pak Quantity		
	in	mm	in	mm	in	mm	in	mm	in	mm	in	mm	Shipping Wt. (Approx.) lbs	kgs		No. of Pieces	
GRO-1/2-UL	0.500	12.70	.03-.08	.76-2.03	0.28	7.11	0.81	20.57	0.54	13.72	0.41	10.41	6	2.7	5000	1000	GRO-1/2-UL
GRO-5/8-UL	0.625	15.88	.03-.08	.76-2.03	0.31	7.87	0.93	23.62	0.66	16.76	0.52	13.21	8	3.6	5000	1000	GRO-5/8-UL
GRO-3/4-UL	0.750	19.05	.03-.08	.76-2.03	0.35	8.89	1.06	26.93	0.79	20.07	0.65	16.51	10	4.5	5000	1000	GRO-3/4-UL
GRO-7/8-UL	0.875	22.23	.03-.08	.76-2.03	0.35	8.89	1.19	30.22	0.91	23.11	0.77	19.55	15	6.8	5000	1000	GRO-7/8-UL
GRO-1-UL	1.000	25.40	.03-.08	.76-2.03	0.35	8.89	1.32	33.53	1.04	26.42	0.89	22.61	12	5.4	5000	1000	GRO-1-UL
GRO-1-1/4-UL	1.250	31.75	.03-.08	.76-2.03	0.35	8.89	1.60	40.64	1.29	32.77	1.12	28.45	11	4.9	2500	500	GRO-1-1/4-UL

## TES Series

Caplug No.	Dimensions						Packaging				Caplug No.
	A		B		C		Standard Carton		Mini Pak Quantity		
	in	mm	in	mm	in	mm	Shipping Wt. (Approx.) lbs	kgs		No. of Pieces	
TES-1	5.38	136.66	0.50	12.70	1.13	28.70	10	4.5	5000	N/A	TES-1



# WRAPS & DISCS

## MTG, MTB, MTK Series Polyester and Polyimide Masking Tape for Powder Coating



Caplugs High Temperature Masking Tapes are ideal for masking applications during powder coating, plating and finishing. Series MTG is a 2-Mil polyester film backing with a 1.5-Mil silicone adhesive that offers superior resiliency at temperatures up to 400°F (204°C). Series MTB, a thinner (0.75-Mil polyester film/2.25-Mil adhesive) version of MTG, is stocked in a blue color and is ideal for masking curved surfaces. Series MTK, with a Kapton® polyimide film backing, will withstand temperatures up to 500°F (260°C).



### SPECIFICATIONS:

#### MTG Green Masking Tape

**Backing** Polyester  
**Material:** Polyester  
**Thickness:** 2.0 Mil  
**Color:** Green  
**Temperature:** 400°F (204°C)

**Adhesive** Silicone  
 1.5 Mil  
 Clear

#### MTK Gold Kapton® Masking Tape

**Backing** Polyimide  
**Material:** Polyimide  
**Thickness:** 1.0 Mil  
**Color:** Gold  
**Temperature:** 500°F (260°C)

**Adhesive** Silicone  
 1.5 Mil  
 Clear

#### MTB Blue Masking Tape

**Backing** Polyester  
**Material:** Polyester  
**Thickness:** 0.75 Mil  
**Color:** Blue  
**Temperature:** 400°F (204°C)

**Adhesive** Silicone  
 2.25 Mil  
 Clear

## MDG, MDK Series Polyester and Polyimide Masking Discs for Powder Coating



Caplugs Masking Discs are available from stock in two styles: Series MDG, a 2-Mil polyester film backing with a 1.5-Mil silicone adhesive that offers a superior resiliency at temperatures up to 400°F (204°C); and Series MDK, which has a Kapton® polyimide film backing that will withstand temperatures up to 500°F (260°C). Caplugs Masking Discs have broad applications in powder coating, electroplating, chrome plating, anodizing and solder wave applications.

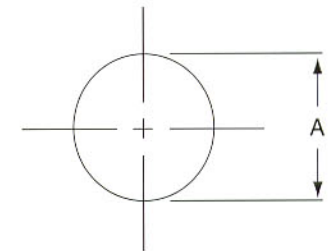
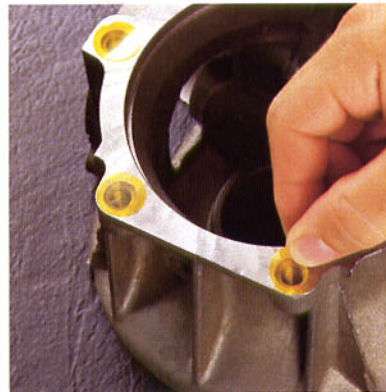

#### MDG Green Masking Disc

**Backing** Polyester  
**Material:** Polyester  
**Thickness:** 2.0 Mil  
**Color:** Green  
**Temperature:** 400°F (204°C)

**Adhesive** Silicone  
 1.5 Mil  
 Clear

#### MDK Gold Kapton® Masking Disc

**Backing** Polyimide  
**Material:** Polyimide  
**Thickness:** 1.0 Mil  
**Color:** Gold  
**Temperature:** 500°F (260°C)

**Adhesive** Silicone  
 1.5 Mil  
 Clear



## MTG, MTB, MTK Series

Caplug No.	Dimensions				Packaging			Mini Pak Quantity	Caplug No.
	A		Length Per Roll		Standard Carton				
	in	mm	yds	m	Shipping Wt. (Approx.)		No. of Rolls		
				lbs	kgs				
<b>MTG Green Masking Tape</b>									
MTG 1/2-72	0.50	12.70	72	21.95	2	0.9	6	N/A	MTG 1/2-72
MTG 3/4-72	0.75	19.05	72	21.95	2	0.9	4	N/A	MTG 3/4-72
MTG 1-72	1.00	25.40	72	21.95	3	1.3	5	N/A	MTG 1-72
MTG 1 1/2-72	1.50	38.10	72	21.95	4	1.8	5	N/A	MTG 1 1/2-72
MTG 2-72	2.00	50.80	72	21.95	5	2.2	5	N/A	MTG 2-72
<b>MTB Blue Masking Tape</b>									
MTB 1/2-72	0.50	12.70	72	21.95	2	0.9	6	N/A	MTB 1/2-72
MTB 1-72	1.00	25.40	72	21.95	3	1.3	4	N/A	MTB 1-72
MTB 1 1/2-72	1.50	38.10	72	21.95	4	1.8	5	N/A	MTB 1 1/2-72
MTB 2-72	2.00	50.80	72	21.95	5	2.2	5	N/A	MTB 2-72
<b>MTK Gold Kapton® Masking Tape</b>									
MTK 1/2-36	0.50	12.70	36	10.97	2	0.9	6	N/A	MTK 1/2-36
MTK 1-36	1.00	25.40	36	10.97	3	1.3	4	N/A	MTK 1-36

## MDG, MDK Series

Caplug No.	Dimensions			Packaging			Mini Pak Quantity	Caplug No.	
	A		Discs Per Roll	Standard Carton					
	in	mm		Shipping Wt. (Approx.)		No. of Rolls			
				lbs	kgs				
<b>MDG Green Masking Disc</b>									
MDG 1/4-2000	0.25	6.35	2000	1	0.4	1	N/A	MDG 1/4-2000	
MDG 3/8-2000	0.38	9.65	2000	1	0.4	1	N/A	MDG 3/8-2000	
MDG 1/2-2000	0.50	12.70	2000	1	0.4	1	N/A	MDG 1/2-2000	
MDG 3/4-1000	0.75	19.05	1000	2	0.9	1	N/A	MDG 3/4-1000	
MDG 1-500	1.00	25.40	500	2	0.9	1	N/A	MDG 1-500	
<b>MDK Gold Kapton® Masking Disc</b>									
MDK 1/4-2000	0.25	6.35	2000	1	0.4	1	N/A	MDK 1/4-2000	
MDK 3/8-2000	0.38	9.65	2000	1	0.4	1	N/A	MDK 3/8-2000	
MDK 1/2-2000	0.50	12.70	2000	1	0.4	1	N/A	MDK 1/2-2000	
MDK 3/4-1000	0.75	19.05	1000	2	0.9	1	N/A	MDK 3/4-1000	
MDK 1-500	1.00	25.40	500	2	0.9	1	N/A	MDK 1-500	